

PARTS Bulletin

URGENT: Please distribute copies for the following people within your organization:

Owner ☒ Sales ☒ Customer Service ☒ Service Techs ☒

Parts Bulletin #2 June 2016

To: All VSGA Distributors

Subject: Return line for HF9000

Ladies and Gentlemen,

In order to solve the trouble caused by small leaking of the cylinder and to prolong the lifetime of the cylinder, we design the return line for HF9000.

For the lifts produced after 2015, the parts needed are already packaged with the lift.

For the lifts produced before 2015, if the cylinder failed, the lift will need the HF9000 feedback line kit to install the return line, But now only the lift with Power unit PDL4421 can install return line, PU JT-3-2.5 and JT-2-2.5H cannot be used to install return line.

HF9000 feedback line kit contains the parts below:

PART NO	DISCRIPTION	QTY
YG30-9100G3	cylinder	1
50.02.06.03	Hose	0.22m
50.02.06.03	Hose	2.52m
EPL8-03	Elbow	1
EPC8-02	Elbow	1
SPM-8	Elbow	1

Part number: 108, 109, 110, 111,112 are new added parts for the lift.

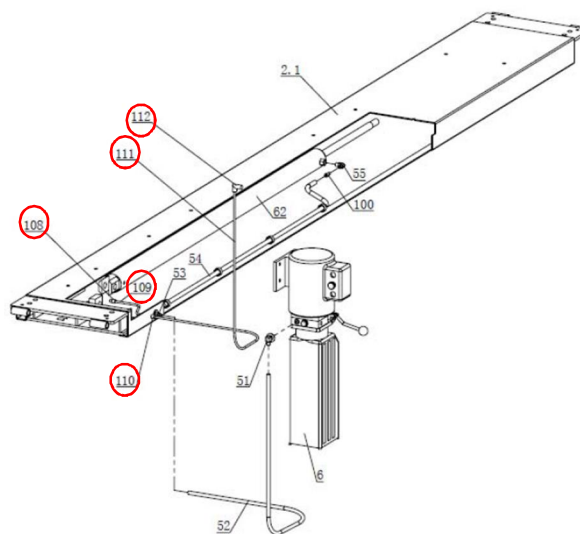

(Detail Installation information please check technical file: Installation instruction on return line of HF9000.)

Sincerely,

Xiaowei Yin
Technical Support Engineer